

Munich Residence

Residence Museum
Treasury
Cuvilliés-Theatre

For centuries the Munich Residence was the political and cultural centre of first the Dukes, then the Electors (from 1623) and finally the Kings of Bavaria (1806–1918). As the seat and centre of government of the Wittelsbachs, the history of the Residence is inseparable from that of Bavaria's ruling dynasty. The various rulers furnished and extended the rooms to suite their own personal tastes. The Residence was also the place where rulers kept their art collections and treasure. The collections and historic state rooms were opened to the public in 1920.

Opening hours Residence Museum, Treasury and Cuvilliés-Theatre:

1 April – 15 October: 9am – 6pm
16 October – 31 March: 10am – 4pm
Daily open

♿ Museum rooms only accessible via a number of steps or a staircase

The Cuvilliés-Theatre is closed for restoration until 2008. The Residence Museum has a separate morning and afternoon tour.

A free audioguide (German, English, French, Italian, Spanish) to the Residence Museum and the Treasury can be obtained at the entrance.

The official guides with a detailed description of the sights can be obtained at the cash desk.
The room numbers in the ground plan correspond to those of the official guide book.

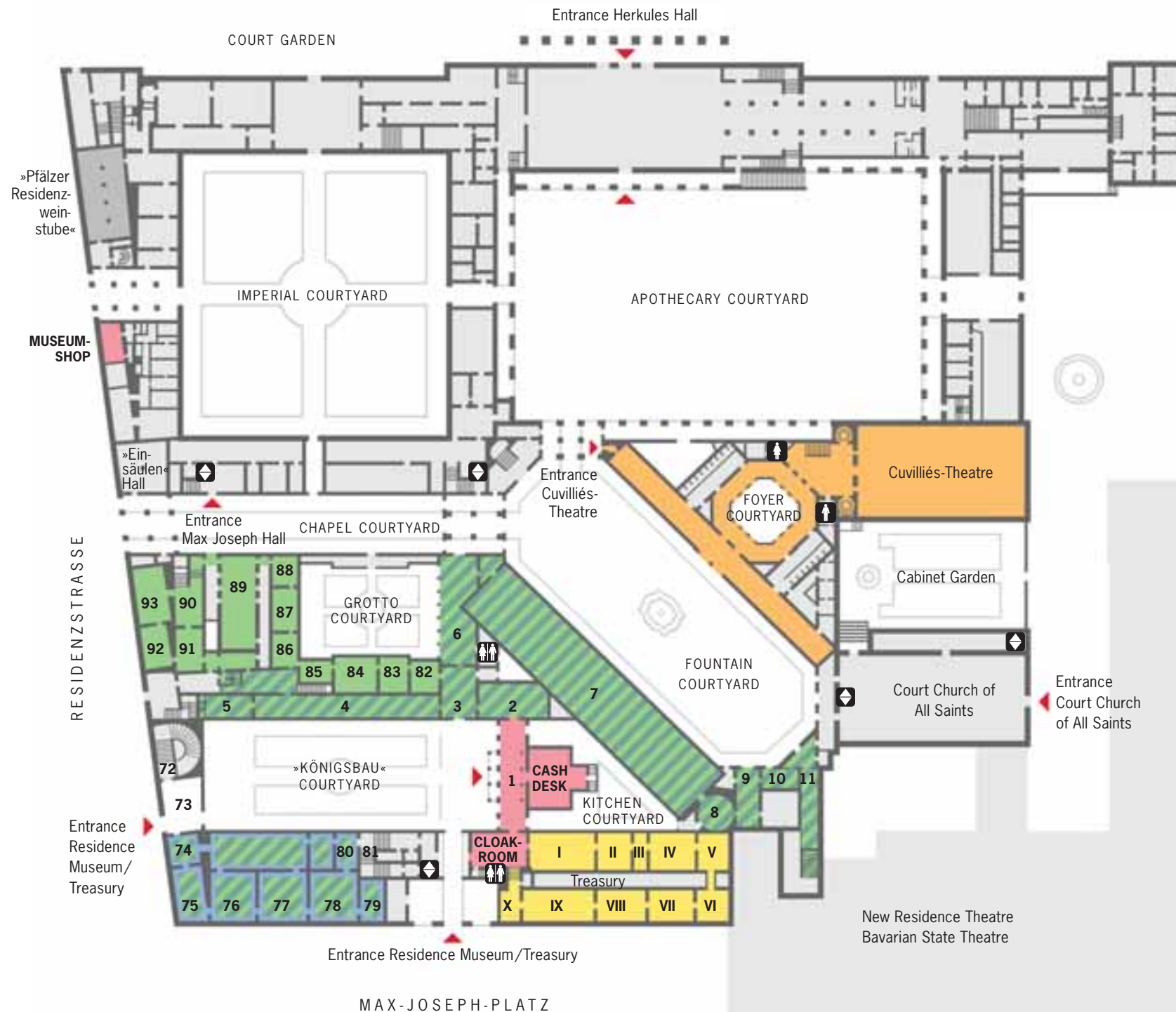

Residence Museum/Groundfloor

- 1 Vestibule
- 2-3 Garden Halls
- 4-5 Ancestral Gallery and Porcelain Cabinet
- 6 Grotto Courtyard
- 7 Antiquarium (Hall of Antiquities)
- 8-11 Octagon and Stairs to the Black Hall
- 74-80 Nibelungen Halls and Exhibition »Destruction and Reconstruction«
- 82-88 Porcelain Chambers (European porcelain of the 18th century)
- The Porcelain Chambers are unfortunately closed for renovation until further notice.**
- 89 Court Chapel
- 90 Chapel Staircase
- 91-93 Sacred Vestments Rooms

Treasury

- I-X Goldsmith's work spanning several centuries from the Middle Ages to the era of classicism, orders and insignia, tableware, religious art, priceless objects made of ivory, rock crystal and precious stones

Cuvilliés-Theatre

Created in 1751–55 by the architect François Cuvilliés the Elder and Munich court artists, this court theatre is a masterpiece of Rococo art

Entrances, Cash desk, Shop, Cloakroom

Tour I (mornings)

Tour II (afternoons)

The Nibelungen Halls and the exhibition »Destruction and Reconstruction« can be visited separately from the tour

Treasury

Cuvilliés-Theatre

Rooms, that are not part of the museum

Entrances

Toilets / Elevator

Residence Museum/Upper Floor

- 13 Black Hall ■■
- 14a-14c »Schlachtsäle« (Battle Halls) ■■
- 14d-14g Porcelain Chambers (European porcelain of the 19th century) ■■
- 15-20 Collection of East Asian Porcelain ■■
- 21 Nottbohm Collection of Miniatures ■■
- 22-31 Electoral Chambers ■■
- 32 All Saints' Corridor ■■
- 33-41 So-called Court Garden Rooms and Charlotte Chambers ■■
- 42-45 Charlotte Corridor and Broad Staircase ■■
- 46-53 »Trierzimmer« (Treves Rooms) ■■
- 54 Hall of the knights of St. George ■■
- 55-62 Rich Rooms with Green Gallery and Miniature Cabinet ■■
- 63-70 Chinese Cabinet and so-called Papal Chambers ■■
- 71-72 Golden Hall and Queen-Mother-Staircase ■■
- 94 Chapel Stairway ■■
- 95 Reliquaries Chamber ■■
- 96 Gallery of the Court Chapel ■■
- 97-98 Vestibule and Rich Chapel ■■
- 99 Antler Corridor ■■
- 100-103 Silver Chambers and Bodyguards' Hall ■■
- 104-109 »Steinzimmer« (Stone Rooms) ■■
- 110-114 Four White Horses Hall, Imperial Hall, Imperial Staircase and Theatiner Corridor ■■
- 115-127 Appartements of the »Königsbau« (Royal Palace) ■■

- Tour I (mornings)
- Tour II (afternoons)
- Rooms, that are not part of the museum
- ♿ Toilets / ⬇ Elevator

Information: Verwaltung der Residenz München
 Residenzstraße 1 · 80333 München
 Tel. (0 89) 2 90 67-1 · Fax (0 89) 2 90 67-225
 ResidenzMuenchen@bsv.bayern.de

Further information:

 Bayerische Verwaltung der staatlichen Schlösser, Gärten und Seen
 Postfach 202063 · 80020 München
 Tel. (0 89) 17 90 80 · Fax (0 89) 17 90 81 54
 info@bsv.bayern.de · www.schloesser.bayern.de

9/2005

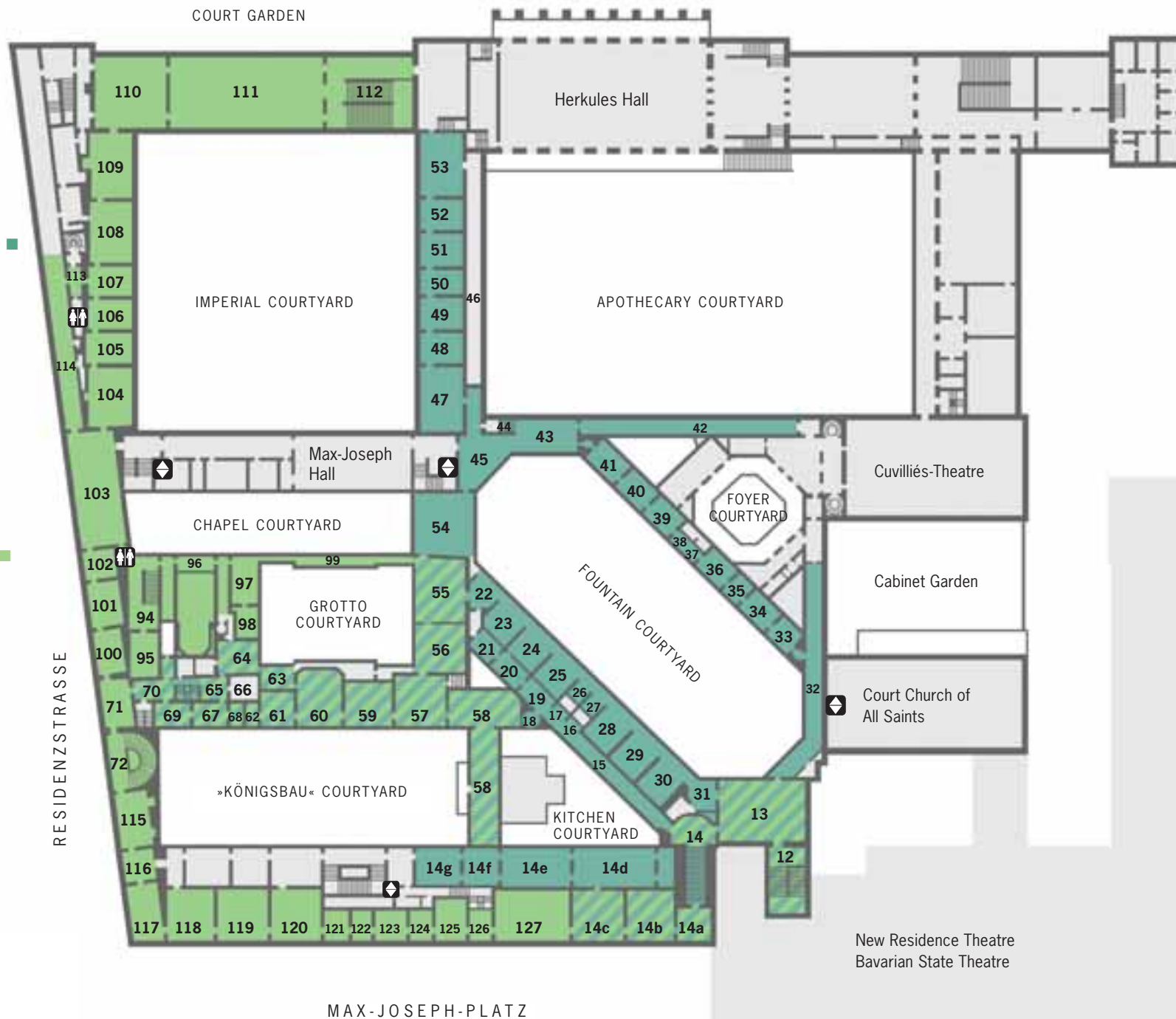

Munich Residence

RESIDENCE MUSEUM
 TREASURY
 CUVILLIÉS-THEATRE



Bayerische Schlösserverwaltung